



COOL CAPS
INDUSTRIES

THE PERFECT CLOSURE FOR YOUR BOTTLE

TECHNICAL DATA SHEET

27MM 3 START ALASKA CAP (1.35GMS)

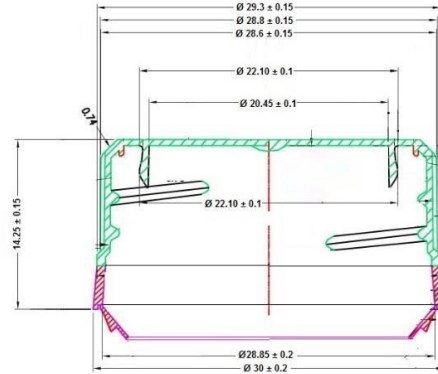

TECHNICAL INFORMATION

MATERIAL	HDPE
NECK SIZE	27MM
WEIGHT	1.35 (+/-0.10) GMS
NO OF KNURLS	120 Knurls
TEMPER EVIDENT BAND	Folded and Slitted TE band
TOP LOAD REQUIREMENT IN FILLING LINE	17-21 Kgs
APPLICATION TORQUE REQUIREMENT	16-17 lbs
OPENING TORQUE	7-13 LBS
LEAKAGE TEST	50 PSI NO LEAKAGE (60 SEC)
CLOSURE O/D (WITHOUT RING)	29.30(+/- 0.15) MM
CLOSURE O/D (WITH RING)	30.00 (+/-0.20) MM
TOTAL HEIGHT	14.25(+/-0.15) MM
THREAD I/D	25.50(+/-0.15) MM
PLUG O/D	22.10(+/-0.15) MM
CAP HEIGHT	14.25(+/-0.15) MM
USE	MINERAL WATER, EDIBLE OIL
COLOR	Custom Colors Accepted

PACKING DETAILS

NO. OF PCS IN A BOX

7500 PCS