



COOL CAPS  
INDUSTRIES

THE PERFECT CLOSURE FOR YOUR BOTTLE

# TECHNICAL DATA SHEET

## 28MM PCO 1881 CAP

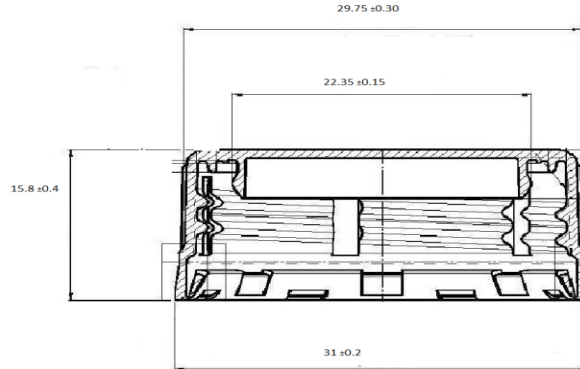

### TECHNICAL INFORMATION

MATERIAL	HDPE
NECK SIZE	28MM PCO 1881
WEIGHT	2.25 (+/-0.10) GMS
NO OF KNURLS	120 Knurls
TEMPER EVIDENT BAND	Folded and Slitted TE band
TOP LOAD REQUIREMENT IN FILLING LINE	17-21 Kgs
APPLICATION TORQUE REQUIREMENT	16-17 lbs
OPENING TORQUE	9-14 LBS
LEAKAGE TEST	1. 100 PSI NO LEAKAGE (60 SEC) 2. 150 PSI NO RELEASE (60 SEC)
CLOSURE O/D (WITHOUT RING)	29.80(+/- 0.35) MM
CLOSURE O/D (WITH RING)	31.00 (+/-0.40) MM
TOTAL HEIGHT	15.80(+/-0.40) MM
THREAD I/D	25.90(+/-0.60) MM
PLUG O/D	22.35(+/-0.15) MM
CAP HEIGHT	14.25(+/-0.15) MM
BRIDGE BREAKING STRENGTH	90(+/-15) N
USE	COLA, SODA, JUICE
COLOR	Custom Colors Accepted

### PACKING DETAILS

NO. OF PCS IN A BOX	5000 PCS
---------------------	----------